

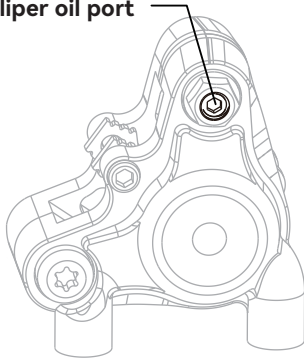

USER MANUAL

Usage Explanation:

Caliper oil port



- It is recommended to use a manual transmission or brake lever with a pump diameter of 9-10mm to ensure the best feel. The working clearance of this caliper is large, please squeeze the brake lever several times after installation to adapt it, and add oil in time.
- Please select the brake fluid and brake handle according to the version you purchased, DOT or Mineral.
- During installation, we suggest resetting the caliper piston (clean any dirt if necessary) to effectively avoid disc rubbing.
- Before installation, please remove holding pads from the caliper, insert the included brake pads, and ensure the fixing screws and retaining clips are in place. DO NOT over tighten the brake pad holding screw.
- Our brakes come with a 3 years warranty. If you have any questions or uncertainties, please feel free to contact us.

LEWIS is dedicated to designing and producing components that consistently remain at the forefront of the cycling industry. Through user data combined with our research and test results, we continuously optimize our products to best serve our customers. We sincerely invite users to report any issues they encounter during the use of our products, either via email or through after-sales feedback to create an unbeatable buying, riding, and after-sales service for everyone. You can follow our various contact methods and multimedia accounts to access technical information or news on new and exciting products. Lastly, we would like to thank you for your support of and trust in LEWIS. Now get out there and ride!

Safety Information

- Please read and review all information carefully before use and always follow the procedures stated in the User's Manual.
- Use caution when using a larger disc brake rotor as it provides a higher braking force.
- The disc brake rotor is sharp enough to inflict severe injury to your fingers if they come in contact with the rotating rotor.
- The brake may not work properly if the brake pads or rotor is contaminated with oil or grease.
- Stop using the brake if the disc brake rotor becomes worn down to it's thickness limit.
- If oil leaks occur, immediately stop using the brakes and consult your closest Lewis dealer.
- The wheel may lock if the front brake is applied too strongly, use caution.
- Braking distance may be longer in humid or wet weather.
- This brake is designed for downhill or free riding, with higher braking force compared to other brakes. If not familiar with this brake, accidents may occur that can cause serious injury or even death.
- If mineral oil comes into contact with eyes and skin, it may result in irritation. If in contact with eyes, rinse with water and receive immediate medical assistance. Inhalation of vapors or mineral oil mist may cause nausea.
- As the brake pads wear out use the bite point adjuster to account for this. Please also note more oil may need to be added to the reservoir.
- **DO NOT** modify this product, doing so will void the warranty.
- Please keep the User's Manual for future reference.

Safety Information

Check the following before riding the bicycle.

- Is the brake leaking oil?
- Do the front and rear brakes work correctly?
- Does each brake pad have a thickness of 0.5 mm or more?
- Is the disc brake rotor cracked or deformed?
- Are there any abnormal noises?
- Is the brake lever secure?
- Is the brake lever action smooth and solid?

If you notice any potential problem, please contact the place of purchase or a bicycle dealer.



BB2 Caliper Diagram

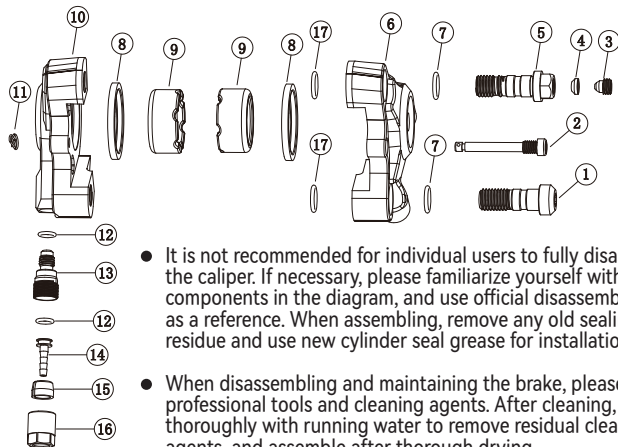

- It is not recommended for individual users to fully disassemble the caliper. If necessary, please familiarize yourself with the components in the diagram, and use official disassembly videos as a reference. When assembling, remove any old sealing adhesive residue and use new cylinder seal grease for installation.
- When disassembling and maintaining the brake, please use professional tools and cleaning agents. After cleaning, rinse thoroughly with running water to remove residual cleaning agents, and assemble after thorough drying.

Serial No.	Component Name	Quantity
1	Calipers lock screw	1
2	Pad Pin	1
3	Set screw	1
4	O-RING	1
5	Oil plug screw	1
6	Lower Shell	1
7	O-RING	2
8	Piston seal (21)	2
9	Piston (21)	2
10	Upper shell	1
11	Circlip	1
12	O-RING	2
13	Oil hose connector	1
14	Oil hose connector	1
15	Oil hose cone cover	1
16	Connector nut	1
17	O-RING	2

Note: The parts in brackets are titanium alloy parts
(The oil hose connector is made of aluminum)

BB2 Caliper Diagram

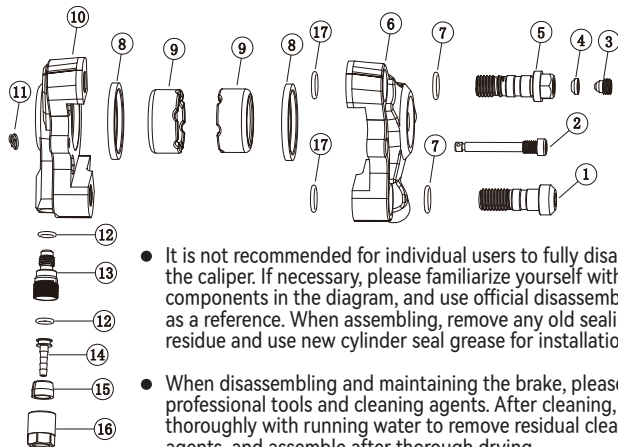

- It is not recommended for individual users to fully disassemble the caliper. If necessary, please familiarize yourself with the components in the diagram, and use official disassembly videos as a reference. When assembling, remove any old sealing adhesive residue and use new cylinder seal grease for installation.
- When disassembling and maintaining the brake, please use professional tools and cleaning agents. After cleaning, rinse thoroughly with running water to remove residual cleaning agents, and assemble after thorough drying.

Serial No.	Component Number	Quantity
1	CLS16(CLS16A)	1
2	CLS21_SUS(CLS21_TAI)	1
3	CLS14(CLS14A)	1
4	CMF04	1
5	CLS15(CLS15A)	1
6	CBT17	1
7	COX560812	2
8	CMF07	2
9	CHS13(CHS08)	2
10	CBT16	1
11	CTH09	1
12	COX255515	2
13	CJT11(CJT11_LV)	1
14	CGT02	1
15	CZT03	1
16	CLS43(CLS43_LV)	1
17	COX480816	2

Note: The parts in brackets are titanium alloy parts
(The oil hose connector is made of aluminum)



LEWIS

**ALL FOR
CYCLING
EXPERIENCE**

POWERED BY:



Website: www.lewisbike.com

